

FERRON MOUNTAIN VIEW SUBDIVISION SE/4 SECTION 16, T 20 S, R 07 E S.L.B. & M.

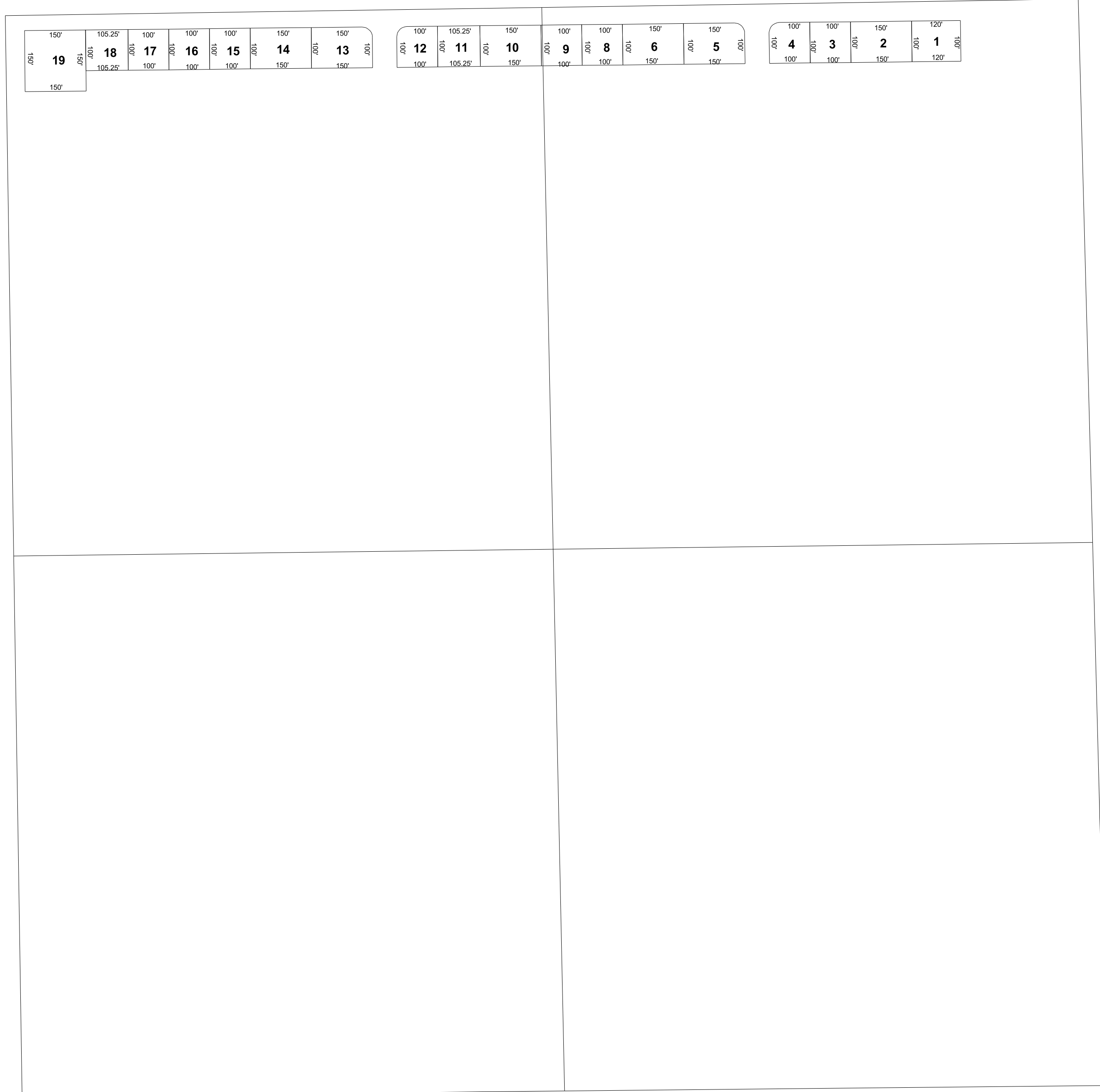

THIS PLAT IS MADE SOLELY FOR THE PURPOSE
OF ASSISTING IN LOCATING THE LAND, AND
THE RECORDER ASSUMES NO LIABILITY FOR
VARIATIONS, IF ANY, WITH AN ACTUAL SURVEY.



- 1-136-1
EASTIN & MOLLY
SCOVILL
0.28 Ac.
- 1-136-2
GREGORY J
& GLENDA D
GUEST, TRUSTEES
0.34 Ac.
- 1-136-3
LOIS S GUEST,
TRUSTEE
0.23 Ac.
- 1-136-4
DENNIS NELSON,
TRUSTEE ETAL
0.23 Ac.
- 1-136-5
G LANE CHYNOWETH
TRUSTEE, ETAL
0.34 Ac.
- 1-136-6
ROBERT EARL
BLACKBURN, ETAL
0.34 Ac.
- 1-136-8
JOHN T & LINDA D
ELLIS
0.23 Ac.
- 1-136-9
BRETT BEHLING
0.23 Ac.
- 1-136-10
ETHAN T &
HEIDI MIGLIORI
0.34 Ac.
- 1-136-11
MESIA NYMAN
0.24 Ac.
- 1-136-12
LARRY D &
ANNETTE W
SALING
0.23 Ac.
- 1-136-13
JERRY L &
TOINETTE N
THOMAS
0.34 Ac.
- 1-136-14
RICHARD L &
EMILY NELSON,
TRUSTEES
0.34 Ac.
- 1-136-15
STEVEN L &
MICHELLE C
CHRISTENSEN,
TRUSTEES
0.23 Ac.
- 1-136-16
RONALD LEE &
COLLEEN N
TENNANT
0.23 Ac.
- 1-136-17
TYRELL K &
MISTIE ANN
BENNETT
0.23 Ac.
- 1-136-18
BRENT C &
RENEE W
TAYLOR
0.24 Ac.
- 1-136-19
KENT BLAINE &
BARBARA B
MCKELL
0.52 Ac.